

Sidmouth Cycle Route – Extension to Woolbrook

Report of the Head of Planning, Transportation and Environment

Please note that the following recommendations are subject to consideration and determination by the Committee before taking effect.

Recommendation: It is recommended that:

- (a) the scheme shown on plan B2300281/HATOC/01 is approved at an estimated cost of £100,000, to be funded from Section 106 developer contributions;**
- (b) procedures be commenced to seek planning consent for the scheme; and**
- (c) formal negotiations be commenced to agree terms for the land required.**

1. Summary

This report seeks approval to a proposed scheme to provide an improved shared use walking and cycling route from the Byes to the Woolbrook area of Sidmouth.

2. Background/Introduction

The walking and cycling route known as The Byes extends from Salcombe Road, near the centre of Sidmouth, to Byes Lane in Sidford. Proposals are currently being developed for an extension of the route northwards to Sidbury. In 2012, a new link from The Byes to Sidmouth College was completed. The purpose of the scheme outlined in this report is to create a new link from The Byes to Woolbrook Road, providing improved access to the schools and local shops in the area. As well as a cycle link, the scheme will provide improved facilities for pedestrians, including those accessing the nearby bus stops.

In the longer term, this scheme could also form part of a strategic 16km long multi use trail from Sidmouth to Ottery St Mary and Feniton, mainly following the line of the disused railway.

3. Proposals

The attached plan no. B2300281/HATOC/01 shows the proposed scheme, which includes the following main elements:

- (a) The widening, to 3m, of an existing path through Long Park, from the Alexandria Road/Manstone Avenue junction to Arcot Road. The alignment shown diagrammatically on the plan will be sympathetically varied to prevent damage to tree roots and to avoid the need to move benches, utility cabinets or other street furniture. A safe separation will also be maintained between the path and the gate to the childrens' play area.**
- (b) The upgrading of the existing pedestrian refuge near the Arcot Road junction to a toucan crossing. It will be necessary, subject to consents, to remove a section of hawthorn hedge approximately 3m long to provide a safe access between the path in Long Park and the new toucan crossing.**
- (c) The signing/marketing of a connecting cycle route from the proposed new toucan crossing to The Byes, via Lymebourne Park and Lymebourne Lane.**

It is understood that planning consent for the widening of the path through Long Park will be required. The works will also be subject to the agreement of East Devon District Council and Sidmouth Town Council as landowners.

4. Consultation

Initial consultation has taken place with East Devon District Council and Sidmouth Town Council and further negotiations will follow as part of the planning consent and land agreement procedures. The local Member has also been closely involved in the development of the scheme and is fully supportive of the proposals.

5. Financial Considerations

The total estimated cost of the scheme is £100,000, for which Section 106 developer funding has been made available by East Devon District Council. It is a requirement that the works are completed in the financial year 2014/15.

6. Sustainability Considerations

The proposals will have a positive impact by encouraging more people to walk and cycle. The provision of improved walking and cycling routes, helping to reduce dependence on private car use, is a key element of the County Council's sustainable transport policy

7. Carbon Impact Considerations

The proposals will have a positive carbon impact by helping to reduce levels of car use.

8. Equality Considerations

No new policies are being recommended in this report and therefore an Equality Impact and Needs Assessment is not considered necessary.

9. Legal Considerations

The lawful implications/consequences of the proposals have been considered and taken into account in the preparation of this report.

10. Risk Management Considerations

This proposal has been assessed and all necessary safeguards or actions have been taken to safeguard the Council's position.

11. Public Health Impact

The scheme will have a positive public health impact by encouraging increased walking and cycling, with associated personal health benefits.

12. Options/Alternatives Investigated

An alternative to the proposed toucan crossing would be a zebra crossing, but this would not cater for cyclists using the route. Alternative routes for the off-road section of path through Long Park were considered, but the recommended alignment, close to the south-western boundary, is the most direct and convenient.

13. Reason for Recommendation/Conclusion

The proposed scheme will help to reduce levels of car use and will potentially help to stimulate the local economy by encouraging increased cycle tourism.

Dave Black
Head of Planning, Transportation and Environment

Electoral Division: Sidmouth Sidford

Local Government Act 1972: List of Background Papers

Contact for enquiries: Richard Oldfield

Room No: ABG, Lucombe House, County Hall, Exeter. EX2 4QD

Tel No: (01392) 382092

Background Paper	Date	File Ref.
------------------	------	-----------

None

ro200514edh
hk/cr/Sidmouth cycle route extension to Woolbrook
04 110614

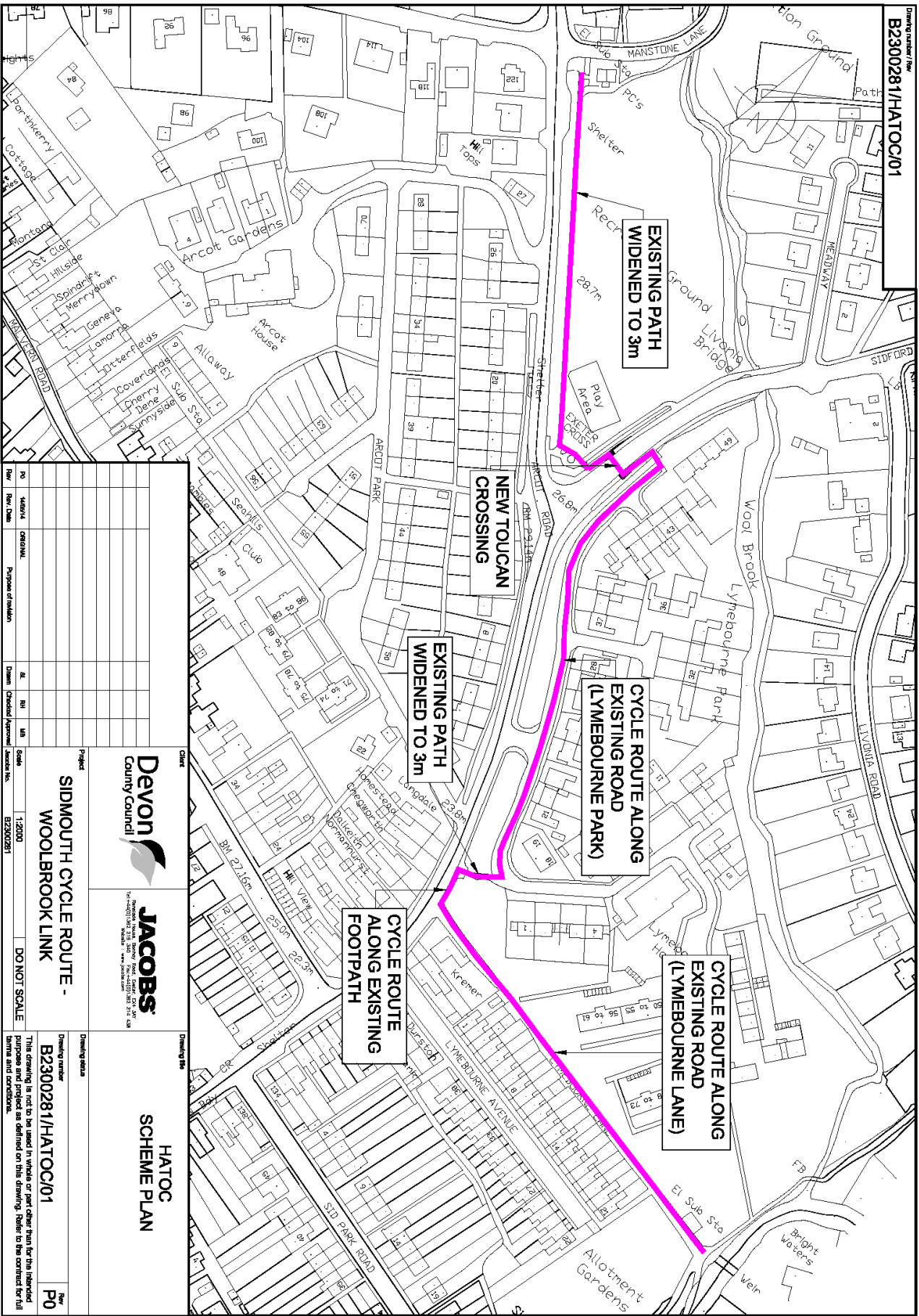

NO	DATE	ORIGINATOR	PURPOSE OF REVISION	BY	CHKD	APPROVAL	SCALE
Rev	Rev/Date						

Client	Project	Drawing title
Devon County Council	SIDMOUTH CYCLE ROUTE - WOOLBROOK LINK	HATOC SCHEME PLAN

Scale	1:2000	DO NOT SCALE
Project No.	B2300281	

Drawing number	B2300281/HATOC/01
Rev	P0

This drawing is not to be used in whole or part other than for the intended purpose unless it is defined on this drawing. Refer to the contract for full terms and conditions.

